

CASE STUDY

Kerfkore Collaborates  
on Columns for  
San Diego Steakhouse

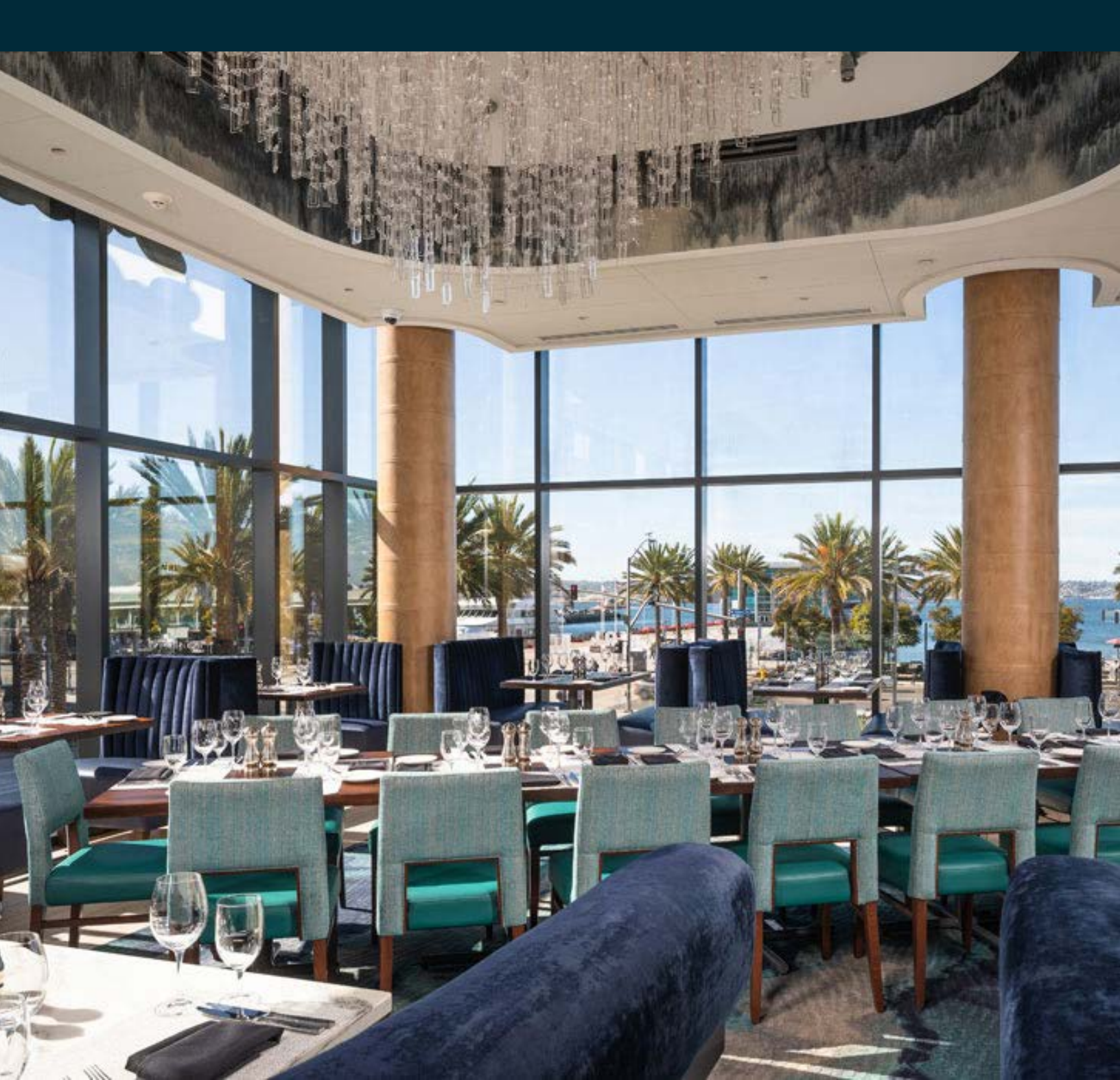

Kerfkore and Ecodomo®, a sustainable leathers and fabrication company, collaborated to create a set of beautiful columns for a steak house nestled in the San Diego bay.

## THE CUSTOMER

Ecodomo®, based in Gaithersburg, Maryland, develops, manufactures, and designs genuinely sustainable leather products for applications in interior design and furnishings.

Their work has graced luxury hotels, restaurants, retail stores, and homes all around the world. Some of the brands Ecodomo has worked with include Starbucks®, Bank of America, Google, Coach, and Marriot Hotels®, amongst other commercial and residential designer and architect firms.

## THE OPPORTUNITY

Ecodomo was tasked with creating leather-bound columns for Del Frisco's Double Eagle Steakhouse located in San Diego, California. The restaurant, an upscale American steakhouse that offers sweeping views of the San Diego Bay and the historic North Embarcadero neighborhood, needed a distinctive accent that matched its high-quality fare and breathtaking views.

The fabricators at Ecodomo began searching for a material that would provide the flexibility and stability needed to form the required radius of the columns. The material had to allow for the application of a leather veneer without comprising the smooth and seamless leather finish.





## THE SOLUTION

Ecodomo's search ended when they met the team at Kerfkore and discovered Flexboard®, which featured the perfect amount of flexibility, stability, and consistency to allow the leather materials to adhere to the 16' high columns.

**“The process of working with the Kerfkore team was great,”**



**Chrisitan Nadeau,**  
President of Ecodomo

said Chrisitan Nadeau, President of Ecodomo. “We reached out to the technical department to review the scope of the project and how to best construct columns using Kerfkore.”

One of Ecodomo's recycled leather veneers was used as the finish on the columns. These veneers come in a variety of colors and textures to suit any style requirement, for this installation they used “Barley Harvest Distressed Buffalo” with gold stitch panels from their Adeline Collection.

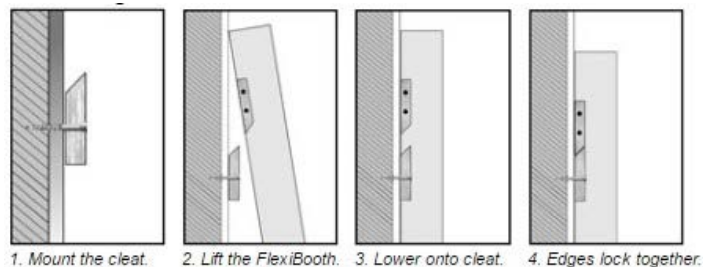

With the materials in hand, Ecodomo attached French cleats to the column structures, which would hold Flexboard to the columns. See the diagram above.

The Flexboard panels were then fastened to the French cleats. The Flexboard panels, each measuring 4' in height, were then laminated with two layers of leather veneers. Each layer of leather was 27" inches wide which allowed the leather to extend 4" beyond the Flexboard panel. Ecodomo then used a self-adhesive so each panel would neatly overlap. This overlap created symmetrical ridges that provided a touch of texture and an organic look.

As a finishing touch, a matching gold seam was stitched into the overlap and a decorative series of nails were used to keep the leather in place.

## THE PRODUCT

Flexboard combines the base layer manufacturing process with a 0.080" FSC Eucalyptus hardboard face to create a stable base layer that allows for easy attachment of high-pressure laminates, veneers, metals, and many other semirigid materials - like Ecodomo's recycled leather veneers.

With Flexboard's smooth Eucalyptus Hardboard face, the column was able to achieve the sleek and opulent look the restaurant desired. Flexboard also features an 8" bending radius, which created an inviting, rounded shape.

---

"The Flexboard was the right thickness, smooth on the surface and [had] no issues and exceeded the radius we had to cover,"

---

Christian said when describing what made Flexboard the right choice for Del Frisco's Double Eagle Steakhouse columns.

## KEY BENEFITS:

- Smooth FSC Eucalyptus Hardboard face
- Flexible base layer
- 8" bending radius
- Laminate curved or flat\*
- Available as a fully FSC certified panel
- Paintable with no prep required

**Flexboard is available in multiple sizes and can be laminated curved or flat, all of which make it an all-star for a variety of projects.\***

\*Laminating Flexboard flat will result in a maximum of a 16" bending radius. For the full 8" bending radius, Flexboard should be laminated curved.

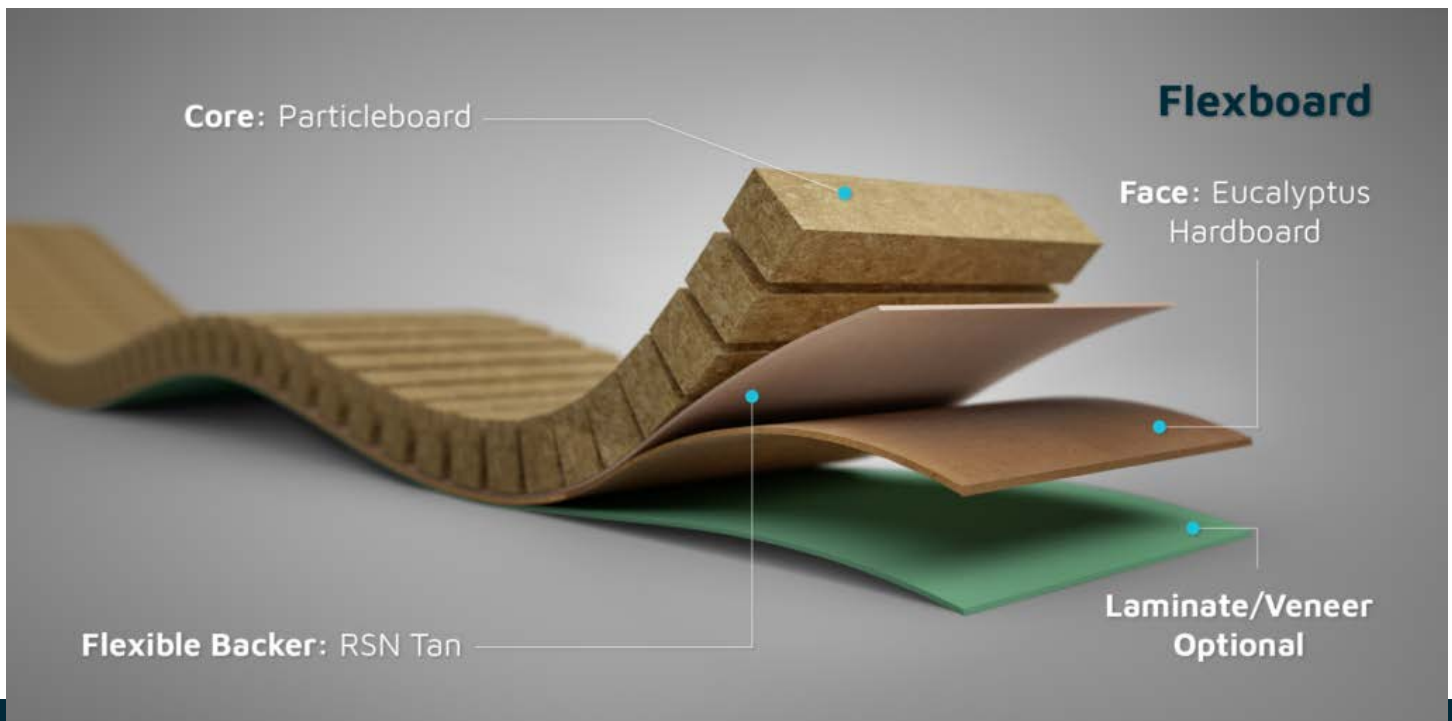



## THE RESULTS

“I personally visited the restaurant on several occasions,” Chrisitan recalls. “The columns are spectacular in the space and the management is pleased with how they turned out. The leather columns add to the space instead of being an obstruction.”

Going forward, Ecodomo plans to utilize Kerfkore products again for another column project in sunny Florida.

---

 **KERFKORE**

See where our flexible panels can take your next project. [Request a sample today!](#)

